

REV	DATE	DRN	CKD	NOTES
A	22.06.22	LS	LG	Fallen tree removed

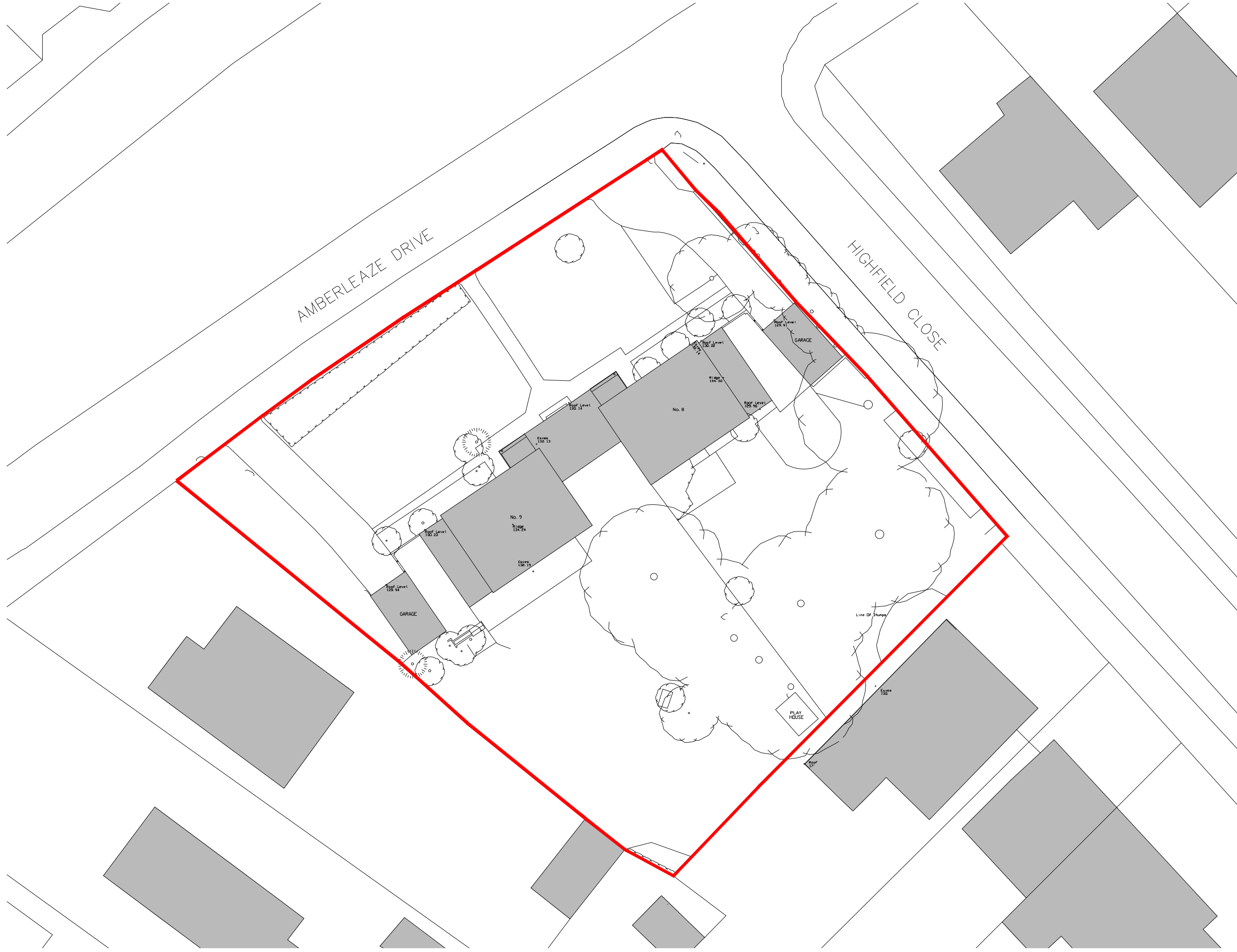

Drawing Key:



PLANNING

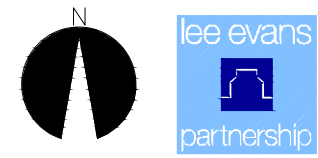

chartered architects and planning consultants

Lee Evans Partnership LLP,  
Canterbury: St Johns Lane, Canterbury, Kent CT1 2DD Tel: 01227 784444  
London: 31-35 Abney Street, London EC1N 8TE Tel: 0207 492 1744  
email: architects@lee-evans.co.uk website: www.lee-evans.co.uk Fax: 01227 819102

PROJECT  
B-9 Amberleaze Drive, Pembury : Kent Police

CLIENT  
The Police and Crime Commissioner for Kent 22/06/2022

DRAWING TITLE  
EXISTING SITE LAYOUT PLAN LS LG

ISSUE STATUS  
PLANNING DRAWING 1:250 @ A3

DRAWING NUMBER  
08719-A-L-(00)-X-0102 A

